



INFILL SOILS RESULT IN INCREASED TARGETS AT GOLD CITY

Highlights

- A 1200m gold in soil geochemical anomaly has been defined by infill sampling around the Gold City historical workings
- Sampling has better defined the gold anomalism of four areas within the broader Gold City prospect
- Permitting for drilling of the new geochemical anomalies is underway – drilling expected to commence early in 2026
- Assays are pending for the recent drilling completed at the main Gold City workings
- Down dip drilling at Van Uden continues and is progressing well

TG Metals Limited (**TG Metals** or the **Company**) (ASX:TG6) is pleased to provide new exploration results for the Gold City prospect (**Gold City**) which lies 20km south of the Van Uden gold deposit (**Van Uden**).

The soil sampling was conducted to provide greater detail for the gold in soil anomalies reported on 7 August 2025. These results of infill sampling have expanded the soil anomaly associated with the historical gold workings in the southern part of the tenement to **1200m in strike** length, (**Figures 1 and 2**), more than double that previously identified. The enhanced and expanded anomaly is located on a topographic high and represents an in-situ soil anomaly.

Additional, infill sampling in the northern part of the Gold City tenement has provided better detail for three (3) additional areas of gold in soil anomalism. Preparations for the drill testing of these anomalies are underway.

TG Metals CEO, Mr. David Selfe stated;

“These results have greatly enhanced the prospectivity of Gold City by increasing the soil anomaly at the old workings area to over 500m in strike and around 400m in width. This strong gold anomaly, together with historical drilling results, confirms Gold City as the Company’s satellite gold project in the region.

After only 8 months of ownership our exploration success at Van Uden is growing the whole project substantially. With four genuine drill targets defined at Gold City, we are confident it will evolve into a much larger opportunity than was evident at acquisition.

We’re looking forward to receiving the first drilling results from the Gold City historical workings area including the downhole telemetry, a great tool for visualising RC drillholes downhole. Approvals are underway as there is a lot more to drill at Gold City. We also look forward to the ongoing results from our Van Uden resource expansion campaign.”

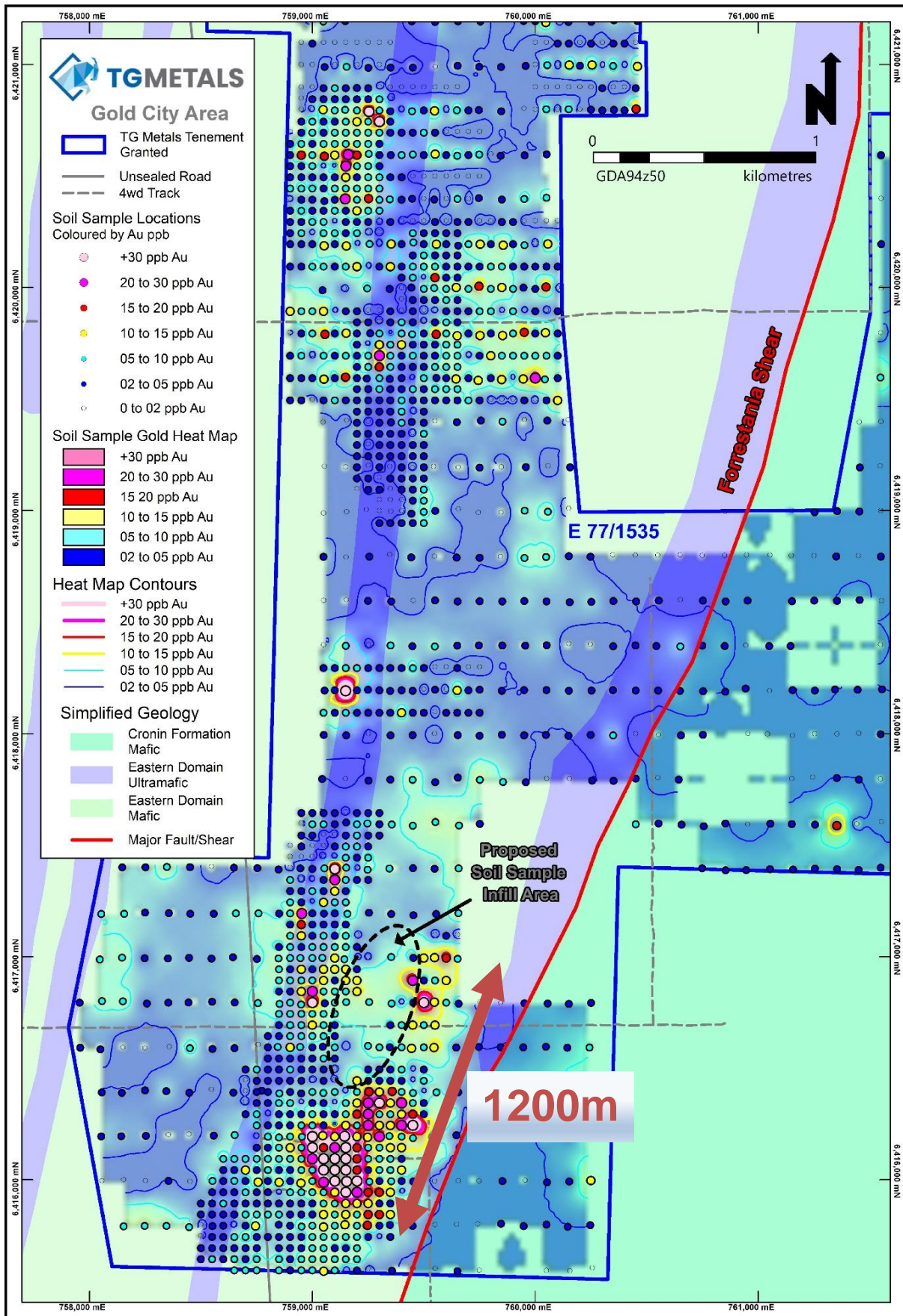

Figure 1 – Soil sampling results at Gold City

For personal use only

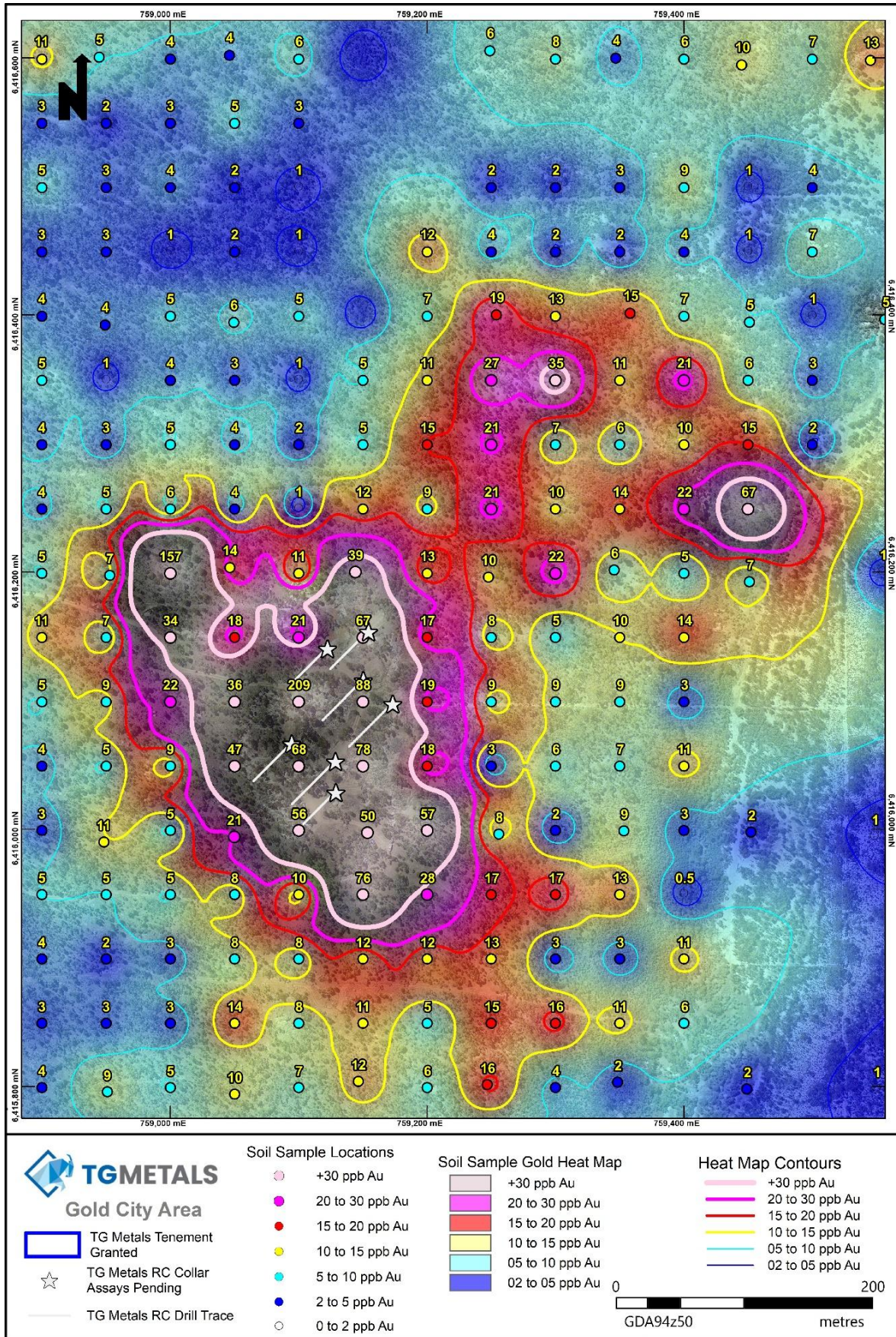

Figure 2 – Gold in soil anomalies including Gold City historical workings area

For personal use only



Soil Sampling

Infill soil sampling was conducted over anomalies first detected in the wide spaced soil sampling grid reported on the 7 August 2025. The infill spacing on select areas was 50m x 50m which is considered suitable for defining future drilling targets. The sampling was conducted by All Points Sampling Australia (APSA) locating data points via hand held GPS.

TG Metals assayed the 50m x 50m soils with 50g fire assay and merged with previously reported data (ASX: 7 August 2025).

Soil sampling results were further analysed with respect to topography, via data collected from a recent LIDAR survey. In addition to topography the LIDAR also identified the presence of historical workings. The majority of these historical workings are located in the southern quarter of the tenement and in the vicinity of the gold in soil anomalies in this southern area.

Gold Anomalies

The largest anomaly is associated partly with historical workings in the southern part of the tenement and appears to have a north-easterly trend for 1200m. Whilst the majority of the old workings are within a topographic low, the expanded soil anomaly is located on a topographic high which negates any soil transportation effects which might influence soil anomalies and their magnitude. The 1200m long anomaly is interrupted by a drainage channel in the centre but continues on to the North-East. On the east side of the topographic high there are small historical workings, identified by LIDAR and also ground truthed. The presence of these workings enhances this expanded soil anomaly as an immediate drill target. It is also apparent that this anomaly has not been closed off to the North West and further infill soil sampling will be conducted to fill in this data gap.

The northern gold in soil anomalies were also infill sampled which has enhanced the definition for future drill planning. Environmental and Heritage surveys are now required in these areas to progress programs of work submissions to DMPE. These northern anomalies are untested by gold focused drilling.

Follow-up Work

Upon receiving all assays from the recent Gold City's drilling program, the immediate historical workings area will be further assessed for additional drilling that can be done under current approvals.

Environmental and Heritage surveys will be completed early in 2026 over the remainder of the drill target areas (gold in soil anomalies) to assist with the approval of Programmes of Work (POWs). Further infill soil sampling will also be done where warranted, to close off the soil anomaly edges and complete the data associated with the 1200m anomaly.

Resource extension drilling continues on the Van Uden deposit, 20km to the north of Gold City and assays are pending. The focus of the current drilling is on down dip extensions to the existing resource.

For personal use only



Van Uden Gold Project Description

The Project is located on the Forrestania Greenstone Belt, **Figure 3**, 90km east-northeast of Hyden and 120km south of Southern Cross. It is close to the Marvel Loch (producing) and Westonia - Edna May (care & maintenance) gold processing Plants and is 130km from the Company's established Burmeister lithium deposit at the Lake Johnston Project.

Van Uden Gold consists of an Indicated and Inferred Mineral Resource as per **Table A** below on four granted mining leases, four granted exploration licences, one exploration licence application and two miscellaneous licences (for haul roads). The Project lies to the west of the Mt Holland lithium mine, south of the operating Marvel Loch gold Plant, and southeast of the Edna May gold Plant.

Mineral Resource Estimate for the Van Uden Gold Deposit - May 2025									
Material	Indicated			Inferred			Total		
	Tonnes	Grade (Au g/t)	Gold (Oz)	Tonnes	Grade (Au g/t)	Gold (Oz)	Tonnes	Grade (Au g/t)	Gold (Oz)
Laterite	234,000	0.9	6,940	525,000	0.7	11,800	759,000	0.7	18,740
Oxide	867,000	1.2	34,200	1,141,000	1.0	38,200	2,008,000	1.0	72,400
Transitional	291,000	1.1	10,700	770,000	1.1	26,500	1,061,000	1.1	37,200
Fresh	318,000	1.6	16,500	2,207,000	1.2	82,300	2,525,000	1.2	98,800
Total	1,710,000	1.2	68,340	4,643,000	1.2	158,800	6,353,000	1.1	227,140

Table A: MRE – Van Uden Gold Deposit

The Mineral Resources statement conforms to the Australasian Code for Reporting of Exploration Results, Mineral Resources and Ore Reserves (JORC Code) 2012 Edition. All tonnages are dry metric tonnes. It has been reported at a cut-off grade of 0.35 g/t Au by area within a A\$5,000/oz Au optimised pit shell based on mining parameters and operating costs typical for Australian open pit extraction deposits of a similar scale and geology. Minor discrepancies may occur due to rounding of appropriate significant figures.

The resources comply with the Reasonable Prospects for Eventual Economic Extraction (RPEEE), a key principle in mineral resource reporting that requires the qualified person to demonstrate that a mineral deposit has the potential to be economically extracted in the future.

About TG Metals

TG Metals is an ASX listed company focused on exploring and developing gold and lithium assets at its wholly owned Lake Johnston Project and 80% owned Van Uden Gold Project in the stable jurisdiction of Western Australia. The Lake Johnston Project hosts the Burmeister high grade lithium deposit, Jaegermeister lithium pegmatites and several surrounding lithium prospects. Burmeister is in proximity to four lithium processing plants and undeveloped deposits. The Van Uden Gold Project contains past producing gold mines and is in proximity to operating gold processing Plants.

Authorised for release by TG Metals Board of Directors.

Contact

Mr David Selfe
Chief Executive Officer
Email: info@tgmets.com.au

Investor Relations

Evy Litopoulous
ResolveIR
Email: evy@resolveir.com

For personal use only

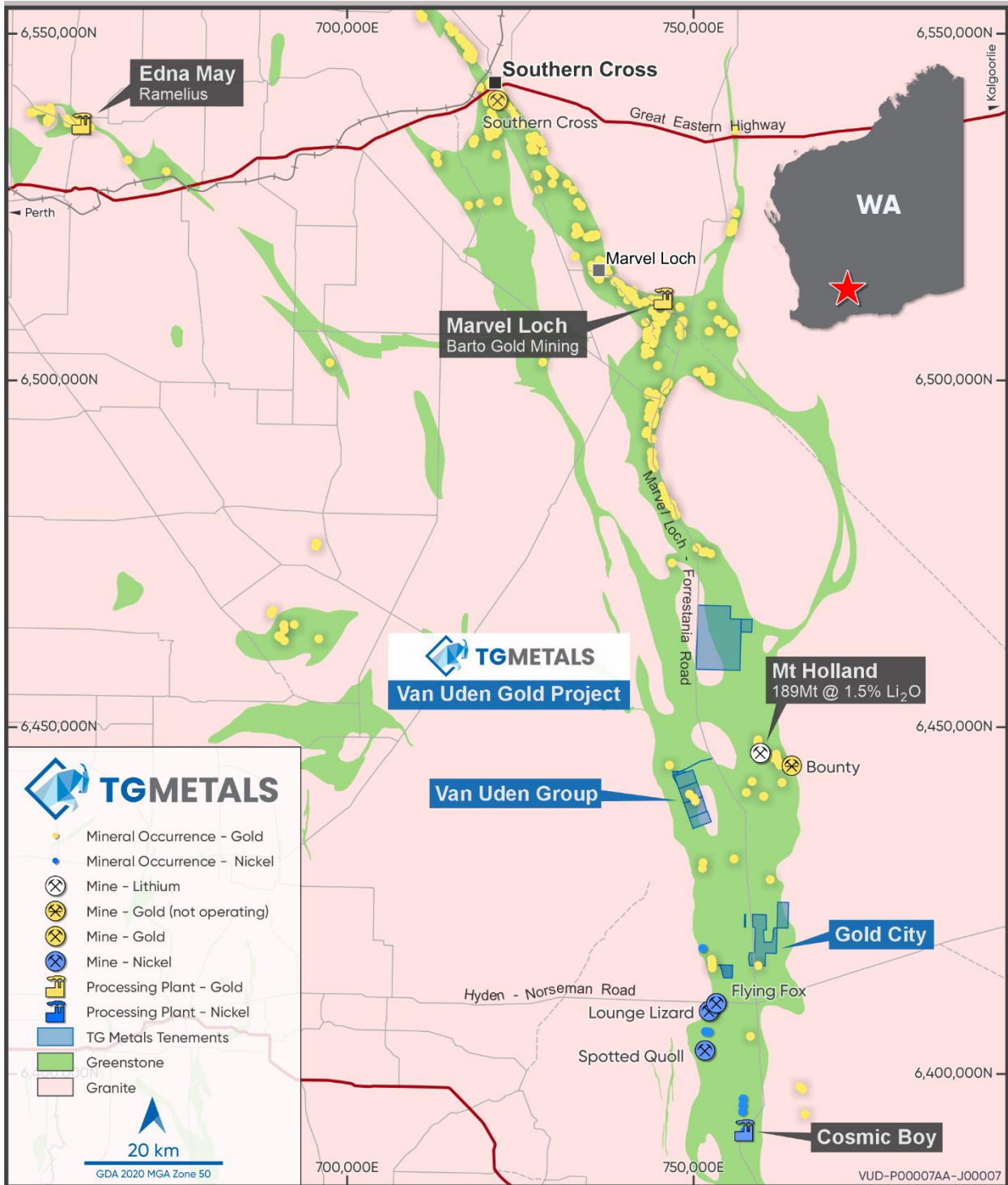

Figure 3 – Location Map showing TG Metals' Van Uden Gold Project



Competent Person Statement

Information in this announcement that relates to exploration results, exploration strategy, exploration targets, geology, drilling and mineralisation is based on information compiled by Mr David Selfe who is a Fellow of the Australasian Institute of Mining and Metallurgy and an employee of TG Metals Limited. Mr Selfe has sufficient experience that is relevant to the style of mineralisation and type of deposit under consideration and to the activities that he is undertaking to qualify as a Competent Person as defined in the 2012 Edition of the Australasian Code for Reporting of Exploration Results, Mineral Resources and Ore Reserves. Mr Selfe has consented to the inclusion in this report of matters based on their information in the form and context in which it appears. Mr Selfe considers that the information in this announcement is an accurate representation of the available data and studies for the Van Uden Gold Project.

Forward Looking Statements

This announcement may contain certain statements that may constitute “forward looking statements”. Such statements are only predictions and are subject to inherent risks and uncertainties, which could cause actual values, results, performance achievements to differ materially from those expressed, implied or projected in any forward looking statements.

Forward-looking statements are statements that are not historical facts. Words such as “expect(s)”, “feel(s)”, “believe(s)”, “will”, “may”, “anticipate(s)” and similar expressions are intended to identify forward-looking statements. These statements include, but are not limited to statements regarding future production, resources or reserves and exploration results. All such statements are subject to certain risks and uncertainties, many of which are difficult to predict and generally beyond the control of the Company, that could cause actual results to differ materially from those expressed in, or implied or projected by, the forward-looking information and statements. These risks and uncertainties include, but are not limited to: (i) those relating to the interpretation of drill results, the geology, grade and continuity of mineral deposits and conclusions of economic evaluations, (ii) risks relating to possible variations in reserves, grade, planned mining dilution and ore loss, or recovery rates and changes in project parameters as plans continue to be refined, (iii) the potential for delays in exploration or development activities or the completion of feasibility studies, (iv) risks related to commodity price and foreign exchange rate fluctuations, (v) risks related to failure to obtain adequate financing on a timely basis and on acceptable terms or delays in obtaining governmental approvals or in the completion of development or construction activities, and (vi) other risks and uncertainties related to the Company’s prospects, properties and business strategy. Our audience is cautioned not to place undue reliance on these forward-looking statements that speak only as of the date hereof, and we do not undertake any obligation to revise and disseminate forward-looking statements to reflect events or circumstances after the date hereof, or to reflect the occurrence of or non-occurrence of any events.

The Company believes that it has a reasonable basis for making the forward-looking Statements in the presentation based on the information contained in this and previous ASX announcements.

The Company is not aware of any new information or data that materially affects the information included in this ASX release, and the Company confirms that, to the best of its knowledge, all material assumptions and technical parameters underpinning the exploration results in this release continue to apply and have not materially changed.

JORC Code, 2012 Edition – Table 1

Section 1 Sampling Techniques and Data

Criteria	JORC Code explanation	Commentary
Sampling techniques	<ul style="list-style-type: none"> <i>Nature and quality of sampling (eg cut channels, random chips, or specific specialised industry standard measurement tools appropriate to the minerals under investigation, such as down hole gamma sondes, or handheld XRF instruments, etc). These examples should not be taken as limiting the broad meaning of sampling.</i> <i>Include reference to measures taken to ensure sample representivity and the appropriate calibration of any measurement tools or systems used.</i> <i>Aspects of the determination of mineralisation that are Material to the Public Report.</i> <i>In cases where 'industry standard' work has been done this would be relatively simple (eg 'reverse circulation drilling was used to obtain 1 m samples from which 3 kg was pulverised to produce a 30 g charge for fire assay'). In other cases more explanation may be required, such as where there is coarse gold that has inherent sampling problems. Unusual commodities or mineralisation types (eg submarine nodules) may warrant disclosure of detailed information.</i> 	<p>Soil samples were collected by All Points Sampling Australia using a spade to a nominal depth of approximately 20 cm, with shallower depths where shallow bedrock was encountered. The –2 mm fraction was sieved in the field to obtain approximately 1 kg of material per sample. Samples were placed in pre-numbered calico bags and dispatched to Jinning Laboratory, 40 Sorbonne Crescent, Canning Vale, Western Australia for analysis by Fire Assay (Au).</p> <p>Soil sampling was conducted on an E–W orientated (50m x 50m) grid designed to infill around previous Montague Resources Pty Ltd soil sampling which was initially undertaken for lithium and later re-assayed by TG Metals Limited for gold. The infill program aimed to refine and expand known anomalies in the vicinity of historical workings and structural trends identified in the region.</p> <p>All samples for assay were submitted to AA Certified Laboratory – Jinning Pty Ltd.</p> <p>All samples dispatched to Jinning Laboratory for analysis (Gold - Au) by Fire Assay and Inductively Coupled Optical Emission Spectrometry (ICP-OES).</p>
Drilling techniques	<ul style="list-style-type: none"> <i>Drill type (eg core, reverse circulation, open-hole hammer, rotary air blast, auger, Bangka, sonic, etc) and details (eg core diameter, triple or standard tube, depth of diamond tails, face-sampling bit or other type, whether core is oriented and if so, by what method, etc).</i> 	<p>No drilling results were included in this report.</p>

Criteria	JORC Code explanation	Commentary
Drill sample recovery	<ul style="list-style-type: none"> • <i>Method of recording and assessing core and chip sample recoveries and results assessed.</i> 	No drilling results were included in this report.
	<ul style="list-style-type: none"> • <i>Measures taken to maximise sample recovery and ensure representative nature of the samples.</i> 	No drilling results were included in this report.
	<ul style="list-style-type: none"> • <i>Whether a relationship exists between sample recovery and grade and whether sample bias may have occurred due to preferential loss/gain of fine/coarse material.</i> 	No drilling results were included in this report.
Logging	<ul style="list-style-type: none"> • <i>Whether core and chip samples have been geologically and geotechnically logged to a level of detail to support appropriate Mineral Resource estimation, mining studies and metallurgical studies.</i> 	The soil sampling program included recording of sample substrate, regolith type, and surface observations. All observations were qualitative in nature. No drilling results are included in this report.
	<ul style="list-style-type: none"> • <i>Whether logging is qualitative or quantitative in nature. Core (or costean, channel, etc) photography.</i> 	All observations are qualitative in nature.
	<ul style="list-style-type: none"> • <i>The total length and percentage of the relevant intersections logged.</i> 	No drilling results were included in this report.
Sub-sampling techniques and sample preparation	<ul style="list-style-type: none"> • <i>If core, whether cut or sawn and whether quarter, half or all core taken.</i> 	No drilling results were included in this report.
	<ul style="list-style-type: none"> • <i>If non-core, whether riffled, tube sampled, rotary split, etc and whether sampled wet or dry.</i> 	No drilling results were included in this report.
	<ul style="list-style-type: none"> • <i>For all sample types, the nature, quality and appropriateness of the sample preparation technique.</i> 	Samples were hand-sieved in the field to the –2 mm fraction and collected dry. The sieved material (approximately 1 kg) was dispatched to Jinning Laboratory for homogenisation and pulverisation prior to analysis. The sample size and preparation method are considered appropriate for near-surface gold geochemical sampling. Samples were transported to Jinning for analysis.
	<ul style="list-style-type: none"> • <i>Quality control procedures adopted for all sub-sampling stages to</i> 	No independent QA/QC samples were inserted for this early-stage

Criteria	JORC Code explanation	Commentary
	<p><i>maximise representivity of samples.</i></p> <ul style="list-style-type: none"> <i>Measures taken to ensure that the sampling is representative of the in situ material collected, including for instance results for field duplicate/second-half sampling.</i> <i>Whether sample sizes are appropriate to the grain size of the material being sampled.</i> 	<p>reconnaissance program. QA/QC protocols will be implemented in any follow-up drilling programs once anomalous zones are further defined.</p> <p>The sieved field sample of +1kg was appropriate for the grain size of the surface material.</p> <p>The sample preparation technique and sample size were considered appropriate for the material being sampled.</p>
Quality of assay data and laboratory tests	<ul style="list-style-type: none"> <i>The nature, quality and appropriateness of the assaying and laboratory procedures used and whether the technique is considered partial or total.</i> <i>For geophysical tools, spectrometers, handheld XRF instruments, etc, the parameters used in determining the analysis including instrument make and model, reading times, calibrations factors applied and their derivation, etc.</i> <i>Nature of quality control procedures adopted (eg standards, blanks, duplicates, external laboratory checks) and whether acceptable levels of accuracy (ie lack of bias) and precision have been established.</i> 	<p>All samples dispatched to Jinning Laboratory for analysis (Gold - Au) by Fire Assay and Inductively Coupled Optical Emission Spectrometry (ICP-OES). This analytical method was chosen to detect low level gold as advised by ALS.</p> <p>No other instruments or tools were used during this program.</p> <p>First pass plots of sample replicate repeatability and standard results recorded against expected were within TG Metals Limited acceptable range.</p>
Verification of sampling and assaying	<ul style="list-style-type: none"> <i>The verification of significant intersections by either independent or alternative company personnel.</i> <i>The use of twinned holes.</i> <i>Documentation of primary data, data entry procedures, data verification, data storage (physical and electronic) protocols.</i> 	<p>No drilling results were included in this report.</p> <p>No drilling results were included in this report.</p> <p>Field data was recorded by All Points Sampling Australia and collated by TG Metals Limited. Data was collated in Microsoft Office Excel, formatted with headers and uploaded into TG Metals Limited Micromine Database. Validation errors were rectified during import. TG Metals Limited data and</p>

Criteria	JORC Code explanation	Commentary
	<ul style="list-style-type: none"> <i>Discuss any adjustment to assay data.</i> 	<p>the Microcmine Database are backed up regularly on a secure cloud storage.</p> <p>All data below detection limit were entered as zero in the database. No adjustments were made to the reported assay data.</p>
Location of data points	<ul style="list-style-type: none"> <i>Accuracy and quality of surveys used to locate drill holes (collar and down-hole surveys), trenches, mine workings and other locations used in Mineral Resource estimation.</i> <i>Specification of the grid system used.</i> <i>Quality and adequacy of topographic control.</i> 	<p>All soil sample points were located using handheld GPS with a typical +- 3m accuracy on the X and Y axis.</p> <p>The field datum used was MGA_GDA94, Zone 50. All maps in this report are referenced to GDA94, Zone 50.</p> <p>No topographic control was applied to the data, handheld GPS height was used with a 5 to 10m accuracy on z axis.</p>
Data spacing and distribution	<ul style="list-style-type: none"> <i>Data spacing for reporting of Exploration Results.</i> <i>Whether the data spacing and distribution is sufficient to establish the degree of geological and grade continuity appropriate for the Mineral Resource and Ore Reserve estimation procedure(s) and classifications applied.</i> <i>Whether sample compositing has been applied.</i> 	<p>Soil sample spacing was conducted on a E-W grid pattern 50m x 50m grid and merged with soil data reported (ASX: TG6 7 August 2025)</p> <p>Not applicable for soil sampling.</p> <p>No sample compositing was completed.</p>
Orientation of data in relation to geological structure	<ul style="list-style-type: none"> <i>Whether the orientation of sampling achieves unbiased sampling of possible structures and the extent to which this is known, considering the deposit type.</i> <i>If the relationship between the drilling orientation and the orientation</i> 	<p>The sample grid and pattern was based on the orientation of target structures and previous soil sampling programs The grid was orientated E-W, while the strike of stratigraphy is WNW. This slight offset ensure contacts are covered. This orientation is considered appropriate to test structural controls on mineralisation.</p> <p>No drilling results were included in this report.</p>

Criteria	JORC Code explanation	Commentary
	<i>of key mineralised structures is considered to have introduced a sampling bias, this should be assessed and reported if material.</i>	
Sample security	<ul style="list-style-type: none"> <i>The measures taken to ensure sample security.</i> 	Samples were collected by All Points Sampling Australia (APSA) employees. Field staff recorded the calico number against the geographical coordinates of the sample location on the sampling sheet. The calico containing the sample were securely tied and placed directly in a Bulka bag to be transported to Jinning in Canning Vale, Perth. Laboratory chain of custody procedures were applied.
Audits or reviews	<ul style="list-style-type: none"> <i>The results of any audits or reviews of sampling techniques and data.</i> 	Standards and replicates were cross-checked against expected values. No variances of greater than 2 standard deviations were reported. No external audits or reviews have been conducted for this program.

Section 2 Reporting of Exploration Results

Criteria	JORC Code explanation	Commentary
Mineral Tenement	<ul style="list-style-type: none"> <i>Type, reference name/number, location and ownership including agreements or material issues with third parties such as joint ventures, partnerships, overriding royalties, native title interests, historical sites, wilderness or national park and environmental settings.</i> <i>The security of the tenure held at the time of reporting along with any known impediments to obtaining a licence to operate in the area.</i> 	<p>The reported soil sampling program is located on exploration licence 77/1535 (E77/1535). TG Gold Pty Ltd, a wholly owned subsidiary of TG Metals Limited, entered a Sales and Purchase Agreement on 3 March 2025 with Montague Resources Pty Ltd (Montague) to acquire Montague's 80% interest of E77/1535. TG Gold Pty Ltd has Power of Attorney (PoA – 43367) to manage and operate E77/1535 during the mining title transfer process. The area falls under ILUA legislation, and the claimants are the South West Aboriginal Land & Sea Council Aboriginal Corporation, ICNM 3832 for and on behalf of the Ballardong People Agreement Group.</p> <p>At the time of reporting there were no known impediments to obtaining a license to operate in the area other than TG Metals Limited abiding to conditions set by DMPE. The tenement is in good standing.</p>

Criteria	JORC Code explanation	Commentary
Exploration Done by Other Parties	<ul style="list-style-type: none"> <i>Acknowledgement and appraisal of exploration by other parties.</i> 	<p>Previous work on E77/1535 has been completed by multiple operators, including Montague Resources, which collected soil samples primarily for lithium exploration. TG Metals later re-assayed this dataset for gold, identifying several anomalous areas that guided the current infill program. Other historical explorers include Reynolds Australia, PacMin Mining, Forrestania Gold NL, Sons of Gwalia, and St Barbara Mines Limited.</p>
Geology	<ul style="list-style-type: none"> <i>Deposit type, geological setting and style of mineralization.</i> 	<p>The project lies within the Forrestania Greenstone Belt, west of the Forrestania Shear Zone, where northwest-trending regional shear zones and faults control mineralisation. Gold occurs within sheared mafic and ultramafic sequences associated with historic workings. The area remains underexplored despite the presence of strong structural and geochemical indicators.</p>
Drillhole Information	<ul style="list-style-type: none"> <i>A summary of all information material to the understanding of the exploration results including a tabulation of the following information for all Material drillholes: easting and northing of the drillhole collar elevation or RL (Reduced Level – elevation above sea level in metres) of the drillhole collar dip and azimuth of the hole down hole length and interception depth hole length.</i> 	<p>No drilling results were included in this release.</p>
Data Aggregation Methods	<ul style="list-style-type: none"> <i>In reporting Exploration Results, weighting averaging techniques, maximum and/or minimum grade truncations (e.g. cutting of high grades) and cut-off grades are usually Material and should be stated</i> <i>Where aggregate intercepts incorporate short lengths of high grade results and longer lengths of low grade results, the procedure used for such aggregation should be stated and some typical examples of such aggregation should be shown in detail.</i> <i>The assumptions used for any reporting of metal equivalent values should be clearly stated.</i> 	<p>None used.</p> <p>No data aggregation has been applied to the data presented in this report.</p> <p>No assumptions were made.</p>

Criteria	JORC Code explanation	Commentary
Relationship Between Mineralisation Widths and Intercept Widths	<ul style="list-style-type: none"> <i>If the geometry of the mineralization with respect to the drillhole angle is known, its nature should be reported.</i> 	No drilling results were included in this report.
Diagrams	<ul style="list-style-type: none"> <i>Appropriate maps and sections (with scales) and tabulations of intercepts should be included for any significant discovery being reported. These should include but not be limited to a plan view of drillhole collar locations and appropriate sectional views.</i> 	Refer to the figures in the body of the report.
Balanced Reporting	<ul style="list-style-type: none"> <i>Where comprehensive reporting of all Exploration Results is not practicable, representative reporting of both low and high grades and/or widths should be practiced to avoid misleading reporting of Exploration Results.</i> 	All soil sample results have been reported in grade ranges and visualised via contoured heat maps.
Other Substantive Exploration Data	<ul style="list-style-type: none"> <i>Other exploration data, if meaningful and material, should be reported including (but not limited to): geological observations; geophysical survey results; geochemical survey results; bulk samples – size and method of treatment; metallurgical test results; bulk density, groundwater, geotechnical and rock characteristics; potential deleterious or contaminating substances.</i> 	The dataset complements regional geophysics and historical geochemistry. TG Metals is currently conducting Spring environmental surveys in preparation for future Program of Work (PoW) submissions for drilling.
Further Work	<ul style="list-style-type: none"> <i>The Nature and scale of planned further work (e.g. tests for lateral extensions or depth extensions or large scale step-out drilling).</i> <i>Diagrams clearly highlighting the areas of possible extensions, including the main geological interpretations and future drilling areas, provided this information is not commercially sensitive.</i> 	<p>Follow-up drilling is planned to test the depth extent of surface anomalism defined by the soil program. Results will inform the design of drill traverses for future PoW applications.</p> <p>Refer to the figures in the body of the report.</p>